

Продукция, изготовленная методом литья под давлением

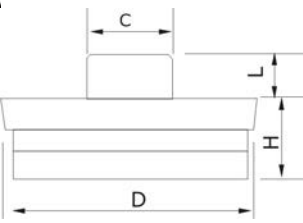

Part No.	D	H	L	C	Colour	Material
140033	4/3"	9mm	4mm	9mm	Br/Wh	ABS and
140030	7/8"	9mm	4mm	9mm	Br/Wh	ABS and
140031	1"	9mm	4mm	9mm	Br/Wh	ABS and
140032	1-1/2"	9mm	4mm	9mm	Br/Wh	ABS and



Part No.	Dia.	H	Colour	Material
140017	32mm	22mm	Wh and Gr	Nylon/Felt



Part No.	Dia.	H	Colour	Material
140070	25mm	9mm	Brown and	TPR and Felt
140071	30mm	9mm	Brown and	TPR and Felt
140072	40mm	9mm	Brown and	TPR and Felt
140073	50mm	9mm	Brown and	TPR and Felt
140074	60mm	9mm	Brown and	TPR and Felt
140075	70mm	9mm	Brown and	TPR and Felt
140076	35x35mm	9mm	Brown and	TPR and Felt
140077	55x55mm	9mm	Brown and	TPR and Felt
140078	25x100mm	9mm	Brown and	TPR and Felt



Part No.	Dia.	H	Colour	Material
140015	28mm	16mm	Black and gray	Nylon/Felt



Part No.	Dia.	H	Colour	Material
140016	32mm	22mm	Wh and Gr	Nylon/Felt



Part No.	Dia.	H	Colour	Material
140050	1-3/8"	8.5mm	Ch/Wh	Nylon/Felt
140051	1-3/8"	11mm	Ch/Wh	Nylon/Felt



Part No.	Dia.	H	Colour	Material
140060	1-1/4"	15mm	Ch/Br/Wh	Nylon/Felt
140061	1-3/8"	15mm	Ch/Br/Wh	Nylon/Felt



Part No.	Size	Colour	Material
140040	7/8"	Br/Wh	HDPE and Felt



Part No.	Dia.	H	Colour	Material
140014	13mm		Black and gray	Nylon/Felt

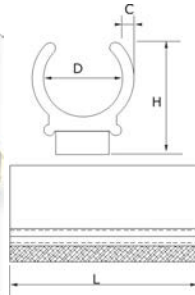
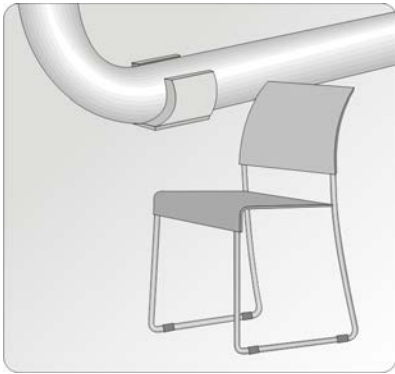

Part No.	D	H	L	C	Colour	Material
140013	1/2"(12.7mm)	22mm	45mm	3mm	Clear	ABS and
140012	5/8"(16mm)	23mm	50mm	3mm	Clear	ABS and
140011	3/4 "(19mm)	24mm	50mm	3mm	Clear	ABS and
140010	1-1/8"(28.6mm)	30mm	15mm	3mm	Clear	ABS and



Part No.	Base dia.	H	Stem thread	Colour	Material
140020	1"	1 1/25"	1/4"-20Sx1"	Brown and Grey	HDPE and Felt
140021	1"	1 1/25"	5/16"-18Sx1"	Brown and Grey	HDPE and Felt



Part No.	Base dia.	H	Stem thread	Colour	Material
140080	18mm	9mm	1/4"-20Sx1"	White and Grey	HDPE and Felt
140081	18mm	9mm	5/16"-18Sx1"	White and Grey	HDPE and Felt