

Ножки промышленные регулируемые

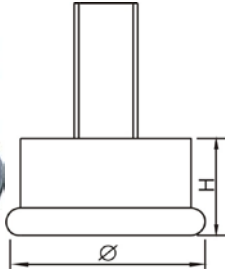

Part No.	Base dia.	H	Stem thread	Colour	Material
110010	7/8"	10.6mm	M7x14.8mm	Black	Nylon/HDPE

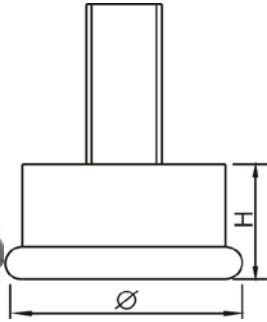

Part No.	Base dia.	H	Stem thread	Colour	Material
110020	7/8"	2/5"	1/4"-20Sx0.5315"	Black	Nylon/HDPE
110021	7/8"	2/5"	M6x13.5mm	Black	Nylon/HDPE

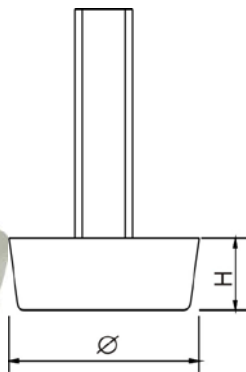

Part No.	Base dia.	H	Stem thread	Colour	Material
110030	7/8"	1/4"	1/4"-20Sx1"	Black/Nature	Nylon/HDPE
110031	7/8"	3/8"	1/4"-20Sx1.5"	Black/Nature	Nylon/HDPE



Part No.	Base dia.	H	Stem thread	Colour	Material
110040	7/8"	1/4"	1/4"- 20Sx0.75"	Grey/Black	Nylon/HDPE
110041	7/8"	1/4"	5/16"-18Sx1"	Grey/Black	Nylon/HDPE

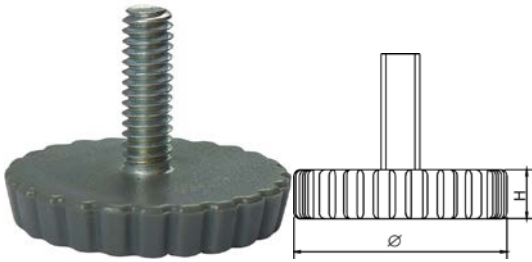

Part No.	Base dia.	H	Stem thread	Colour	Material
110050	1-3/8"	1/4"	1/4"-20Sx0.75"	Grey/Black	Nylon/HDPE
110051	1-3/8"	1/4"	1/4"-20Sx1"	Grey/Black	Nylon/HDPE
110052	1-3/8"	1/4"	5/16"-18Sx1.181"	Grey/Black	Nylon/HDPE
110053	1-3/8"	1/4"	5/16"-18Sx1.732"	Grey/Black	Nylon/HDPE



Part No.	Base dia.	H	Stem thread	Colour	Material
110060	1"	3/8"	1/4"-20Sx0.875"	Nature/Black	Nylon/HDPE
110061	1"	3/8"	1/4"-20Sx1"	Nature/Black	Nylon/HDPE
110062	1"	3/8"	1/4"-20Sx1.5"	Nature/Black	Nylon/HDPE
110063	1"	3/8"	5/16"-18Sx0.875"	Nature/Black	Nylon/HDPE
110064	1"	3/8"	5/16"-18Sx1"	Nature/Black	Nylon/HDPE
110065	1"	3/8"	5/16"-18Sx1.5"	Nature/Black	Nylon/HDPE
110067	1"	3/8"	1/4"-20Sx1.732"	Nature/Black	Nylon/HDPE



Part No.	Base dia.	H	Stem thread	Colour	Material
110070	1"	3/8"	5/16"-18Sx1"	Nature/Black	Nylon/HDPE
110071	1"	3/8"	5/16"- 18Sx1.5"	Nature/Black	Nylon/HDPE
110072	1"	3/8"	3/8"-16Sx1.5"	Nature/Black	Nylon/HDPE
110073	1"	3/8"	3/8"-16Sx2"	Nature/Black	Nylon/HDPE

110080	1-3/8"	2/5"	5/16"-18Sx1" 5/16"-	Nature/Black	Nylon/HDPE
110081	1-3/8"	2/5"	18Sx1.5"	Nature/Black	Nylon/HDPE
110082	1-3/8"	2/5"	3/8"-16Sx1.5"	Nature/Black	Nylon/HDPE
110083	1-3/8"	2/5"	3/8"-16Sx2"	Nature/Black	Nylon/HDPE
110084	1-3/8"	2/5"	1/4"-20Sx1"	Nature/Black	Nylon/HDPE

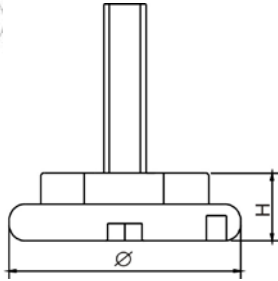

Part No.	Base dia.	H	Stem thread	Colour	Material
110090	1"	3/8"	1/4"-20Sx1"	Nature/Black	Nylon/HDPE
110091	1"	3/8"	1/4"-20Sx1.5"	Nature/Black	Nylon/HDPE
110092	1"	3/8"	5/16"-18Sx1"	Nature/Black	Nylon/HDPE
110093	1"	3/8"	5/16"- 18Sx1.5"	Nature/Black	Nylon/HDPE

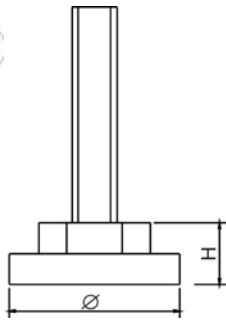

Part No.	Base dia.	H	Stem thread	Colour	Material
110100	1-3/10"	2/5"	1/4"-20Sx1.5"	Nature/Black	Nylon/HDPE
110101	1-3/10"	2/5"	5/16"- 18Sx1.5"	Nature/Black	Nylon/HDPE
110102	1-3/10"	2/5"	3/8"-16Sx1.5"	Nature/Black	Nylon/HDPE



Part No.	Base Diameter	Stem thread	Material
250010	30mm	M10x30mmL	Carbon steel
250011	50mm	M16x50mmL	Carbon steel
250012	80mm	M16x50mmL	Carbon steel
250013	80mm	M16x100mmL	Carbon steel
250014	80mm	M20x75mmL	Carbon steel
250015	100mm	M20x100mmL	Carbon steel

Part No.	Base Diameter	Stem thread	Material
250040	80mm	M16x50mmL	Carbon steel
250041	80mm	M16x100mmL	Carbon steel
250042	80mm	M20x100mmL	Carbon steel
250043	100mm	M16x50mmL	Carbon steel
250044	100mm	M16x100mmL	Carbon steel
250045	100mm	M20x100mmL	Carbon steel
250046	100mm	M20x100mmL	Carbon steel
250047	123mm	M20x100mmL	Carbon steel

250048 123mm M24x100mmL Carbon steel



Part No.	Base Diameter	Stem thread	Material
250080	50mm	M8x50mmL	Carbon steel
250081	50mm	M8x100mmL	Carbon steel
250082	50mm	M10x30mmL	Carbon steel
250083	50mm	M10x50mmL	Carbon steel
250084	50mm	M10x100mmL	Carbon steel
250085	50mm	M12x50mmL	Carbon steel
250086	50mm	M12x100mmL	Carbon steel
250087	60mm	M10x100mmL	Carbon steel
250088	60mm	M12x50mmL	Carbon steel
250089	60mm	M12x100mmL	Carbon steel
250090	80mm	M16x50mmL	Carbon steel
250091	80mm	M16x100mmL	Carbon steel
250092	80mm	M20x100mmL	Carbon steel
250093	100mm	M16x50mmL	Carbon steel
250094	100mm	M16x100mmL	Carbon steel
250095	100mm	M20x50mmL	Carbon steel
250096	100mm	M20x100mmL	Carbon steel
250097	123mm	M20x100mmL	Carbon steel
250098	123mm	M24x100mmL	Carbon steel



Part No.	Base Diameter	Stem thread	Material
250050	50mm	M8x50mmL	Carbon steel
250051	50mm	M8x100mmL	Carbon steel
250052	50mm	M10x30mmL	Carbon steel
250053	50mm	M10x50mmL	Carbon steel
250054	50mm	M10x100mmL	Carbon steel
250055	50mm	M12x50mmL	Carbon steel
250056	50mm	M12x100mmL	Carbon steel
250057	60mm	M10x100mmL	Carbon steel
250058	60mm	M12x50mmL	Carbon steel
250059	60mm	M12x100mmL	Carbon steel
250060	80mm	M16x50mmL	Carbon steel
250061	80mm	M16x100mmL	Carbon steel
250062	80mm	M20x100mmL	Carbon steel



Part No.	Base Diameter	Stem thread	Material
250070	80mm	M16x50mmL	Carbon steel
250071	80mm	M16x100mmL	Carbon steel
250072	80mm	M20x100mmL	Carbon steel
250073	100mm	M16x50mmL	Carbon steel
250074	100mm	M16x100mmL	Carbon steel
250075	100mm	M20x50mmL	Carbon steel
250076	100mm	M20x100mmL	Carbon steel
250077	123mm	M20x100mmL	Carbon steel
250078	123mm	M24x100mmL	Carbon steel



Part No.	Base Diameter	Stem thread	Material
250020	50mm	M8x50mmL	Carbon steel
250021	50mm	M8x100mmL	Carbon steel
250022	50mm	M10x30mmL	Carbon steel
250023	50mm	M10x50mmL	Carbon steel
250024	50mm	M10x100mmL	Carbon steel
250025	50mm	M12x50mmL	Carbon steel
250026	50mm	M12x100mmL	Carbon steel
250027	60mm	M10x100L	Carbon steel
250028	60mm	M12x50mmL	Carbon steel
250029	60mm	M12x100mmL	Carbon steel
250030	80mm	M16x50mmL	Carbon steel
250031	80mm	M16x100mmL	Carbon steel
250032	80mm	M20x100mmL	Carbon steel